

Western  Alumni

PRESENTS

BOAT BIKE TOUR

# Metz to Cochem with Paris

May 17 – 28, 2023 | Hosted by Paul Davenport



Berncastel-Kues



Join Paul Davenport on a cycling tour as you cruise the Moselle River from Metz, France to Cochem, Germany. Enjoy gentle vineyard biking, visit picturesque towns and villages, explore castles and Ancient Roman sites, and indulge in the region's fine Riesling wines.

In between cycling excursions, cruise on board the *Princesse Royale*, exclusively chartered for this group. You'll enjoy breakfast and dinner on board and have a packed lunch to take with you on your daily cycling excursions, usually choosing between and longer or shorter bike rides. You can also spend the day on board enjoying the splendid views on both banks of the Moselle.

The tour begins in Paris where Paul will guide you to two favourite museums and provide personal suggestions for a day on your own. Travel by train to Metz to embark our 31-passenger premium barge for the eight-day cruise on the Moselle disembarking in Cochem to travel by private coach to Frankfurt.

### Reichsburg



### Bernkastel-Kues



### Our premium barge: The *Princesse Royal*

The 31-passenger Dutch-flagged *Princesse Royal* was originally constructed as a seagoing sailing vessel and fully refurbished in 2013. The tastefully furnished lounge on the upper deck has a beautiful bar, a sitting area with cozy corners, the dining area, and large windows. Enjoy the scenery from the partly covered teak sun decks with tables and chairs and the elevated aft deck with a whirlpool/Jacuzzi.

Guests are accommodated in eleven twin cabins (11m<sup>2</sup> – 118.5 ft<sup>2</sup>) with two single beds set next to each other, four premium twin cabins (14 m<sup>2</sup> – 151 ft<sup>2</sup>) with two single beds next to each other and a small sitting area and one single cabin (7 m<sup>2</sup> – 75.5 ft<sup>2</sup>). Beds in most twin cabins can be set together as a double bed. Each cabin has an en-suite bathroom with shower, toilet, and wash basin. All cabins have an individually regulated air conditioning, ventilation system and central heating and are equipped with a flat screen (satellite) TV, mini safe and hair dryer; the portholes in all cabins are fixed for safety reasons.





## Detailed Itinerary

### Wednesday, May 17: Meet in Paris

Guests are met on arrival (one transfer at a designated time) and transferred to our city centre hotel. Late afternoon neighbourhood walk including a visit to Père Lachaise Cemetery.

*Overnight: Hotel Mercure Marais Bastille*

### Thursday, May 18: Paris

Join Paul for visits to two favourite museums.

*Overnight: Hotel Mercure Marais Bastille*

*Meals: Breakfast*

### Friday, May 19: Paris

Enjoy time on your own with suggestions from Paul.

*Overnight: Hotel Mercure Marais Bastille*

*Meals: Breakfast*

### Saturday, May 20: Transfer to Metz and embark

Travel by train from Paris to Metz. On board, settle in, get fitted for your bicycle, and take a little test ride. After dinner enjoy a guided walk in the lovely old city of Metz.

*Overnight: on board Princesse Royal*

*Meals: Breakfast, Dinner*

### Sunday, May 21: Metz to Remich

 **Cycling: 41km or 49km**

Start cycling from the ancient city of Thionville through the lovely French countryside. Pass the Sierck-les-Bains fortress, then cross the border into Luxembourg at the town of Schengen. Admire the tile floor of the Ancient Roman villa in the village of Nennig before finishing in Remich.

*Overnight: on board Princesse Royal*

*Meals: Breakfast, Picnic Lunch, Dinner*

### Monday, May 22: Remich to Saarburg

 **Cycling: 32km**

A choice of two routes today; a shorter more challenging route through the forested hills or a longer easier ride along the river which forms the border between Germany and Luxembourg. Visit a winery producing the famed Moselle 'Cremant' and explore picturesque Saarburg.

*Overnight: on board Princesse Royal*

*Meals: Breakfast, Picnic Lunch, Dinner*

### Tuesday, May 23: Saarburg to Trier

 **Cycling: 32km**

Cycle to Trier in the morning and join your guide for a walk in the oldest city of Germany boasting several impressive monuments from the golden age of Ancient Rome. Enjoy dinner (independent) in Trier.

*Overnight: on board Princesse Royal*

*Meals: Breakfast, Picnic Lunch*

### Wednesday, May 24: Trier to Schweich

 **Cycling: 27km**

#### Schweich to Bernkastel-Kues

 **Cycling: 53km**

Start cycling in Schweich, entering the 'Romantic Moselle' of lovely vineyards as far as the eye can see. The morning cycle takes you to Neumagen, an important wine centre. Join the barge here or continue on cycling to Bernkastel-Kues, a picturesque town with timber-framed houses.

*Overnight: on board Princesse Royal*

*Meals: Breakfast, Picnic Lunch, Dinner*

### Thursday, May 25: Bernkastel-Kues to Zell

 **Cycling: 45km**

Today's route takes you to the romantic village of Trarbach, famed for its art-nouveau architecture to Zell an der Mosel, known for its excellent wine, Schwarze Katze (Black Cat).

*Overnight: on board Princesse Royal*

*Meals: Breakfast, Picnic Lunch, Dinner*

### Friday, May 26: Zell to Cochem

 **Cycling: 39km**

Cycle to the one of the best-preserved and prettiest villages along the river, Beilstein with its ruined castle towering above. Continue on through a landscape of steep wine-clad mountains and wooded hills to the cozy town of Cochem with its picturesque square and majestic Reichsburg Castle.

*Overnight: on board Princesse Royal*

*Meals: Breakfast, Picnic Lunch, Dinner*

### Saturday, May 27: Disembark, transfer to Frankfurt

Disembark after breakfast and transfer by private coach to Frankfurt, stopping for a visit to Eltz Castle and staying overnight at a conveniently located airport hotel.

*Overnight: Hilton Garden Inn, Frankfurt Airport*

*Meals: Breakfast*

### Sunday, May 28: Depart Frankfurt

Our journey concludes after breakfast today. Guests make independent departure arrangements.





## Tour Details

### Tour Cost (per person)\*:

C\$5395 in Twin Cabin

Upgrade to Superior Twin Cabin: C\$350

### Single Supplement:

\$1400 for single occupancy cabin (1 available) | \$1950 for single occupancy of a twin cabin (5 available)

\*based on a minimum of 24 participants

### What's Included:

- Transfer from Paris Charles de Gaulle Airport on arrival (one transfer provided – time to be advised)
- Three nights' accommodation at the Hotel Mercure Paris Bastille Marais or similar, based on double occupancy
- Breakfast daily in Paris
- Entrance fee to two museums in Paris
- Transfer by coach from the Paris hotel to the Paris train station
- Travel by train from Paris to Metz in second class
- Accommodation on board the exclusively chartered Princess Royale May 20 – 27, 2023 travelling from Metz to Cochem, based on double occupancy
- All meals on board ship (except one dinner independent in Trier)
- Rental of bicycle for the duration of the cruise
- Travel by private coach from Cochem to Frankfurt hotel
- One night accommodation at Frankfurt Airport hotel, based on double occupancy and including breakfast

### Not Included:

- Roundtrip airfare from your home to join the tour
- Activities in and around Paris other than two museum entrance fees
- Meals other than those mentioned above
- Beverages with meals
- Ebike rental – available with a supplement of C\$175
- Gratuities
- Fuel surcharges, if applicable
- Items of a personal nature
- Travel insurance (Medical insurance is mandatory, Cancellation and Interruption Insurance is strongly recommended)
- Additional arrangements required due to any emergency or other situation
- Any item not mentioned in “what’s included”

### Payment Details

A non-refundable deposit of C\$750.00 per person is required to reserve a space on this tour. A second payment of C\$1000 per person is due six months prior to departure. Final payment is due 90 days prior to departure.

## Additional Info



### Joining Instructions

This tour begins with arrival in Paris on May 17. A single transfer from the Charles de Gaulle Airport to the hotel is provided. Please contact us to verify timing of this transfer prior to making any flight arrangements. The tour concludes after breakfast on May 28 at the Frankfurt Airport Hotel with easy access to the airport or central train station.



### Level of Activity: Moderate

A good level of fitness is important for this trip. You must be comfortable cycling up to 45km per day on routes graded as 'easy with very flat terrain'. There are opportunities for walks in villages; be prepared for uneven terrain.



### Travel Documents

You will require a passport for this trip. Please ensure it is valid for at least 6 months beyond your scheduled return home. Before booking, please refer to the Canadian government website to obtain travel advice for the destination(s) you are visiting: [www.travel.gc.ca](http://www.travel.gc.ca)



Dining room



Upper Deck Lounge



Premium twin cabin

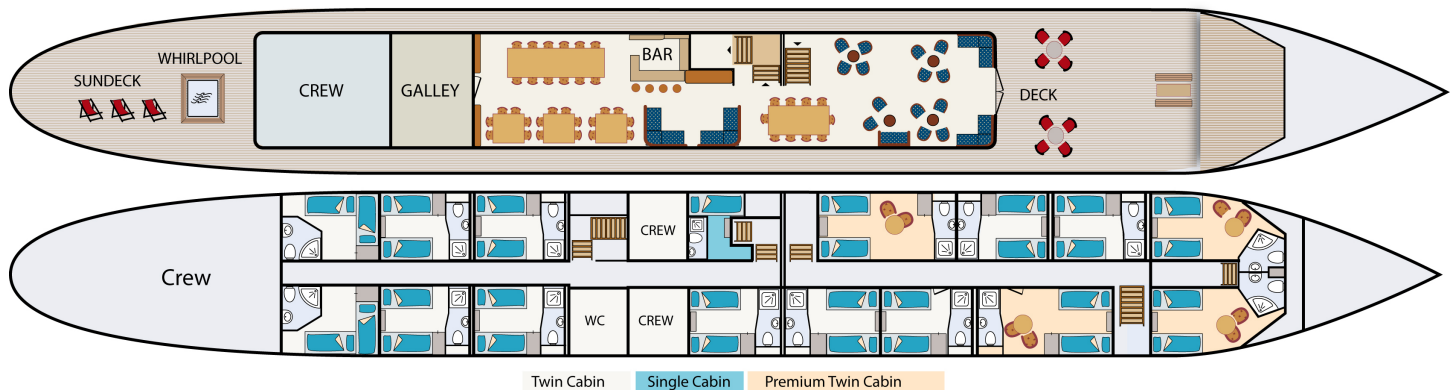

## How to Book

For more information and to book this tour, please contact Akriti at the Worldwide Quest office:

**1-800-387-1483 | 416-633-5666**  
**[travel@worldwidequest.com](mailto:travel@worldwidequest.com)**



TICO#: 2667946